

FILED

IN THE BOARD OF COUNTY COMMISSIONERS OF LANE COUNTY, OREGON AT O'CLOCK M

JUL 30 1980

LANE COUNTY ZONING AND LAND USE ORDINANCE NO. 798

) IN THE MATTER OF REZONING CERTAIN LAND IN SECTION 6.4, TOWNSHIP 18 SOUTH, RANGE 5 WEST, W.M., FROM FARM FORESTRY (FF-20) DISTRICT TO AGRICULTURE, GRAZING AND TIMBER (AGT-5) DISTRICT (ZC 80-4)

LEONOLD, Director of General Services of Lane County
[Signature]
DEPUTY

The Board of County Commissioners of Lane County ordains as follows:

Under authority of the applicable sections of ORS Chs 203 and 215 and Chs 10 and 12 of Lane Code, the land described in Exhibit "A", attached hereto and incorporated herein by reference, is hereby rezoned from Farm Forestry (FF-20) District to Agriculture, Grazing and Timber (AGT-5) District. The property is generally depicted on the attached map.

An emergency is hereby declared to exist and this ordinance, being enacted by the Board in the exercise of its police power for the purpose of meeting such emergency and for the immediate preservation of the public peace, health, and safety, shall take effect immediately upon approval of an Order adopting Findings of Fact in support of this Ordinance.

Enacted this 23rd day of July, 1980.

[Signature]

Chairman, Lane County Board of Commissioners

[Signature]

Recording Secretary for this Meeting of the Board

APPROVED AS TO FORM
DATE 5/1/80
lane county
[Signature]
OFFICE OF LEGAL COUNSEL

After public hearing on March 25, 1980, the rezoning cited in the hereinabove ordinance was approved by the Lane County Planning Commission and is hereby recommended for enactment.

[Signature]

Secretary, Lane County Planning Commission

In the Matter of Rezoning Certain Land in Section 6.4, Township 18 South, Range 5 West, W.M., from Farm Forestry (FF-20) District to Agriculture, Grazing and Timber (AGT-5) District (ZC 80-4)

ZC 80-4
RIDGELY

Beginning at a point on the Southerly right-of-way line of County Road 714 (Perkins Road); said point being South 1615 feet, more or less and West 1650 feet, more or less, from the Brass cap marking the Northeast Corner of Section 6, Township 18 South, Range 5 West of the Willamette Meridian; run thence South 792.0 feet; thence East 550.0 feet; thence South 819.0 feet; thence West 850.0 feet; thence North 1611 feet more or less to the Southerly right-of-way line of said County Road 714; thence Easterly along said Southerly line 300 feet more or less, to the point of beginning and there ending all in Lane County, Oregon.

VICINITY MAP ZC80-4 RIDGLEY

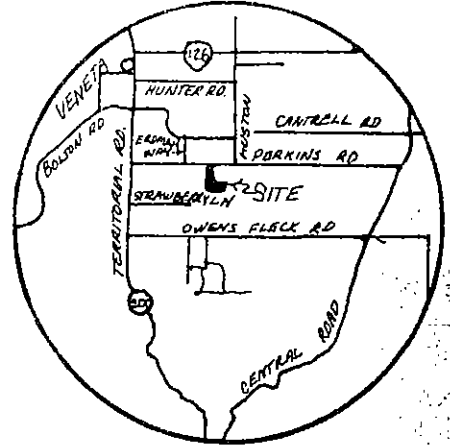

VICINITY MAP
NO SCALE

AGT-5

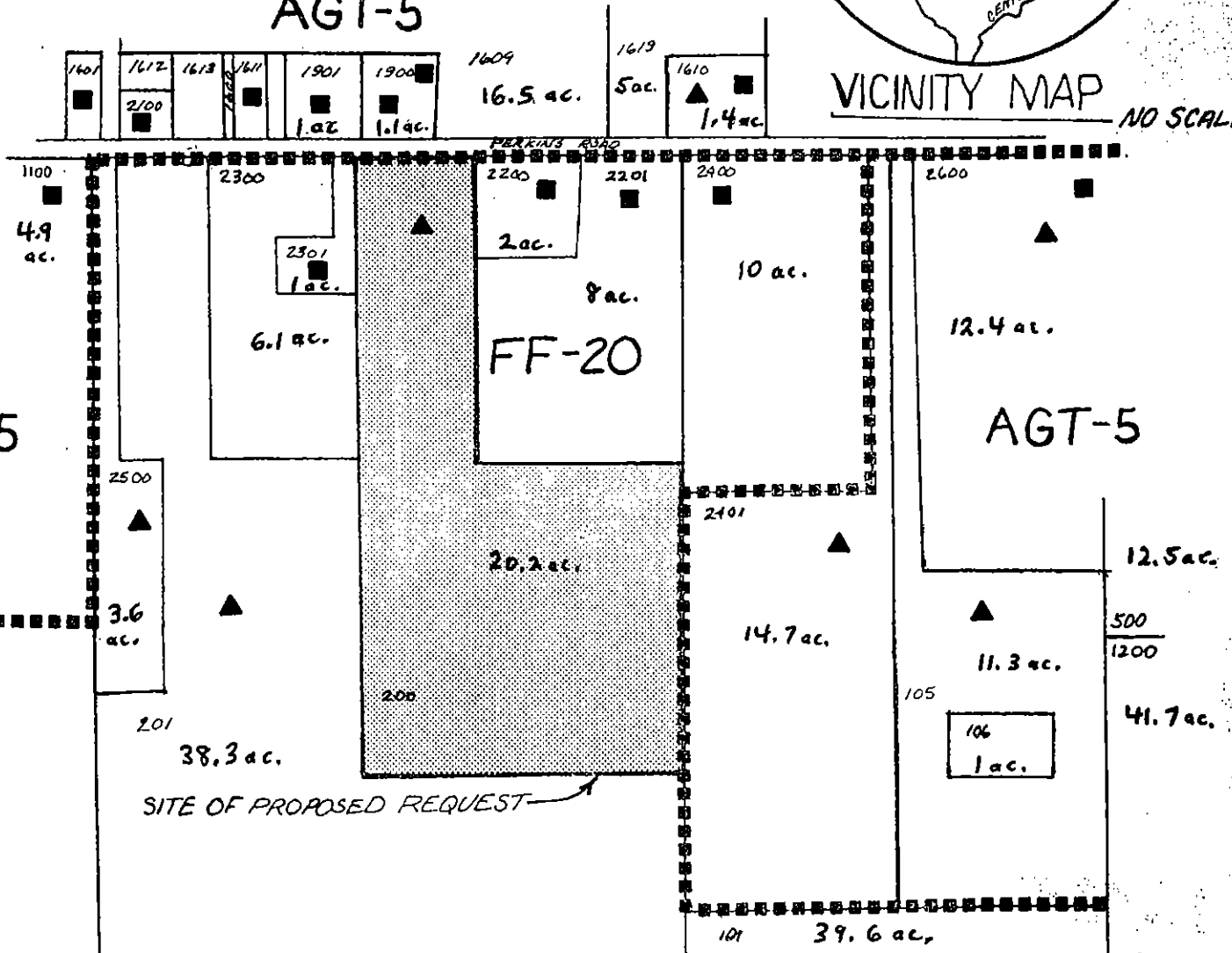

AGT-5

AGT-5

SITE OF PROPOSED REQUEST

■ HOUSE ▲ MOBILE HOME

SOURCE: ASSESSOR + RURAL ADDRESSING RECORDS

ITEM # 4