

IN THE BOARD OF COUNTY COMMISSIONERS OF LANE COUNTY, OREGON

LANE COUNTY ZONING AND LAND USE  
ORDINANCE NO. 799

) IN THE MATTER OF REZONING CERTAIN  
) LAND IN SECTION 32.4, TOWNSHIP 17  
) SOUTH, RANGE 1 WEST, W.M., FROM  
) FARM FORESTRY (FF-20) DISTRICT  
) TO AGRICULTURE, GRAZING AND TIMBER  
) (AGT-5) DISTRICT  
) (ZC 80-16)

**FILED**  
AT ..... O'CLOCK ..... M  
JUL 3 1980  
D. M. PENFOLD, Director of the  
Dept. of General Services of Lane County  
BY *[Signature]* DEPUTY

The Board of County Commissioners of Lane County ordains as follows:

Under authority of the applicable sections of ORS Chs 203 and 215 and Chs 10 and 12 of Lane Code, the land described in Exhibit "A", attached hereto and incorporated herein by reference, is hereby rezoned from Farm Forestry (FF-20) District to Agriculture, Grazing and Timber (AGT-5) District. The property is generally depicted on the attached map.

An emergency is hereby declared to exist and this ordinance, being enacted by the Board in the exercise of its police power for the purpose of meeting such emergency and for the immediate preservation of the public peace, health, and safety, shall take effect immediately upon approval of an Order adopting Findings of Fact in support of this Ordinance.

Enacted this 25th day of June, 1980

*[Signature]*  
Vice Chairman, Lane County Board of Commissioners

APPROVED AS TO FORM  
DATE 5/1/80  
*[Signature]*  
OFFICE OF LEGAL COUNSEL

*[Signature]*  
Recording Secretary for this Meeting of the Board

After public hearing on March 25, 1980, the rezoning cited in the hereinabove ordinance was approved by the Lane County Planning Commission and is hereby recommended for enactment.

*[Signature]*  
Secretary, Lane County Planning Commission

In the Matter of Rezoning Certain Land in Section 32.4, Township 17 South, Range 1 West, W.M., from Farm Forestry (FF-20) District to Agriculture, Grazing and Timber (AGT-5) District (ZC 80-16)

## DESCRIPTION

for

ZC 80-16 ROGERS

Beginning at a point on the South line of Section 32, Township 17 South, Range 1 West of the Willamette Meridian, said point being North 88° 07' West 330.00 feet from the East one-sixteenth (E1/16) corner of the South line of said Section 32; RUN thence North 88° 07' West 554.00 feet; thence North 0° 05' East 817.82 feet; thence North 89° 55' West 682.26 feet; thence North 02° 23' West 270.79 feet; thence North 89° 55' West 201.50 feet to the Easterly dedicated right of way line of County Road Number 703 (Cedar Flats Road); thence Northerly along said easterly right of way of County Road Number 703 to a point on the South line of the North half of the South half of said Section 32; thence South 89° 56' East 65 feet more or less along said South line of the North half of the South half of said Section 32 to the approximate centerline of an unnamed creek; thence Southeasterly along said creek 290 feet, more or less; thence North 14° 41' 20" West 178.00 feet to a point on the said South line of the North half of the South half of said Section 32; thence South 89° 56' East 1200 feet, more or less; thence South 1390.00 feet to the True Point of Beginning, and there ending, all in Lane County, Oregon.

# VICINITY MAP

## ZC 80-16 ROGERS

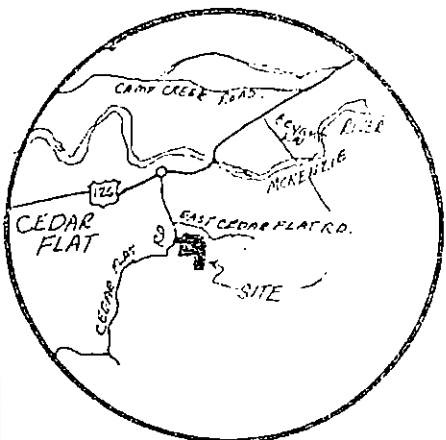

VICINITY MAP

NO SCALE

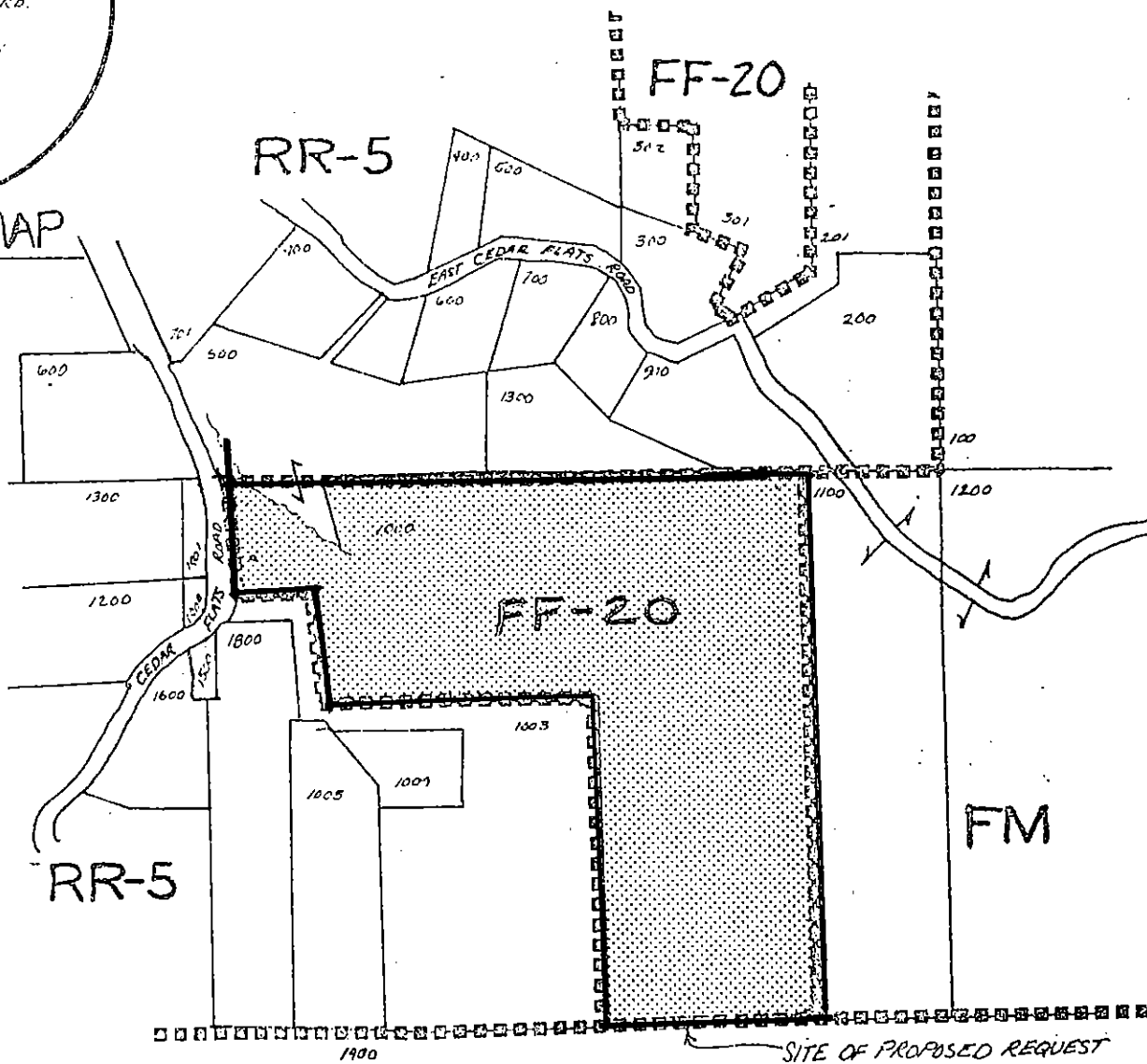

19351