

FILED

IN THE BOARD OF COUNTY COMMISSIONERS OF LANE COUNTY, OREGON

O'CLOCK M

MAR 13 1980

LANE COUNTY ZONING AND LAND USE
ORDINANCE NO. 785

) IN THE MATTER OF REZONING CERTAIN
) LAND IN SECTION 31, TOWNSHIP 17
) SOUTH, RANGE 4 WEST, W.M., FROM
) AGRICULTURE, GRAZING AND TIMBER-20
) (AGT-20) DISTRICT TO GENERAL
) RURAL-10 (GR-10) DISTRICT
) (ZC 79-451)

D.M. PENFOLD, Director of
General Services of Lane County
[Signature]
DEPUTY

The Board of County Commissioners of Lane County ordains as follows:

Under authority of the applicable sections of ORS Chs 203 and 215 and Chs 10 and 12 of Lane Code, the land described in Exhibit "A", attached hereto and incorporated herein by reference, is hereby rezoned from Agriculture, Grazing and Timber-20 (AGT-20) District to General Rural-10 (GR-10) District. The property is generally depicted on the attached map.

An emergency is hereby declared to exist and this ordinance, being enacted by the Board in the exercise of its police power for the purpose of meeting such emergency and for the immediate preservation of the public peace, health, and safety, shall take effect immediately upon approval of an Order adopting Findings of Fact in support of this Ordinance.

Enacted this 4th day of March, 19 80

APPROVED AS TO FORM
DATE 11/30/80
lane county
[Signature]
OFFICE OF LEGAL COUNSEL

[Signature]
Chairman, Lane County Board of Commissioners

[Signature]
Recording Secretary for this Meeting of the Board

After public hearing on January 15, 1980, the rezoning cited in the hereinabove ordinance was denied by the Lane County Planning Commission and is hereby not recommended for enactment.

[Signature]
Secretary, Lane County Planning Commission

In the Matter of Rezoning Certain Land in Section 31, Township 17 South, Range 4 West, W.M., from Agriculture, Grazing and Timber-20 (AGT-20) District to General Rural-10 (GR-10) District
ZC 79-451

DESCRIPTION

for

ZC 79-451

Beginning at a point 22.0 feet East and 35.8 feet North of the South one-quarter (S1/4) corner of Section 31, Township 17 South, Range 4 West, Willamette Meridian, said point being on the Easterly right of way line of County Road Number 361 (commonly known as Oak Hill Road) and the True Point of Beginning; RUN thence North $0^{\circ} 10'$ West 621.59 feet; thence, departing from said Easterly right of way of County Road Number 361, West 404.65 feet; thence North 688.61 feet; thence South $88^{\circ} 23' 30''$ East 234.09 feet; thence North 70.32 feet; thence Easterly 414.86 feet; thence North 525 feet more or less to a point on the Southerly right of way of County Road Number 323 (connector road); thence South $89^{\circ} 15'$ East, along said Southerly right of way line, 659.15 feet to a point on the Westerly right of way line of County Road Number 988 (commonly known as Crow Road); thence, along said Westerly right of way of said County Road Number 988, South $34^{\circ} 32'$ West 1233.80 feet; thence along the arc of a 384.3 foot radius curve left (the long chord of which bears South $22^{\circ} 43'$ West 157.04 feet) a distance of 157.78 feet; thence South $10^{\circ} 55'$ West 748.54 feet; thence, departing from said Westerly right of way line of said County Road Number 988, West 793.30 feet to the True Point of Beginning and there ending, all in Lane County, Oregon.

The bearings used herein are based on Survey Number 6173 on file in the office of the Lane County Surveyor.

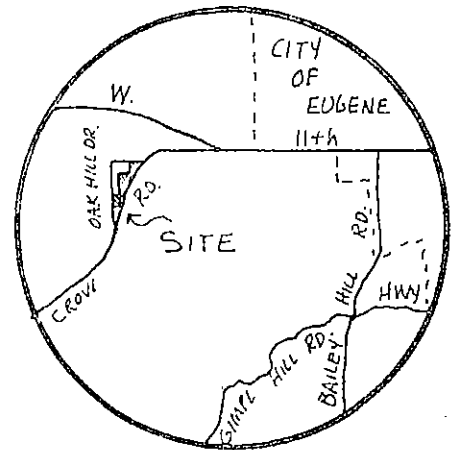
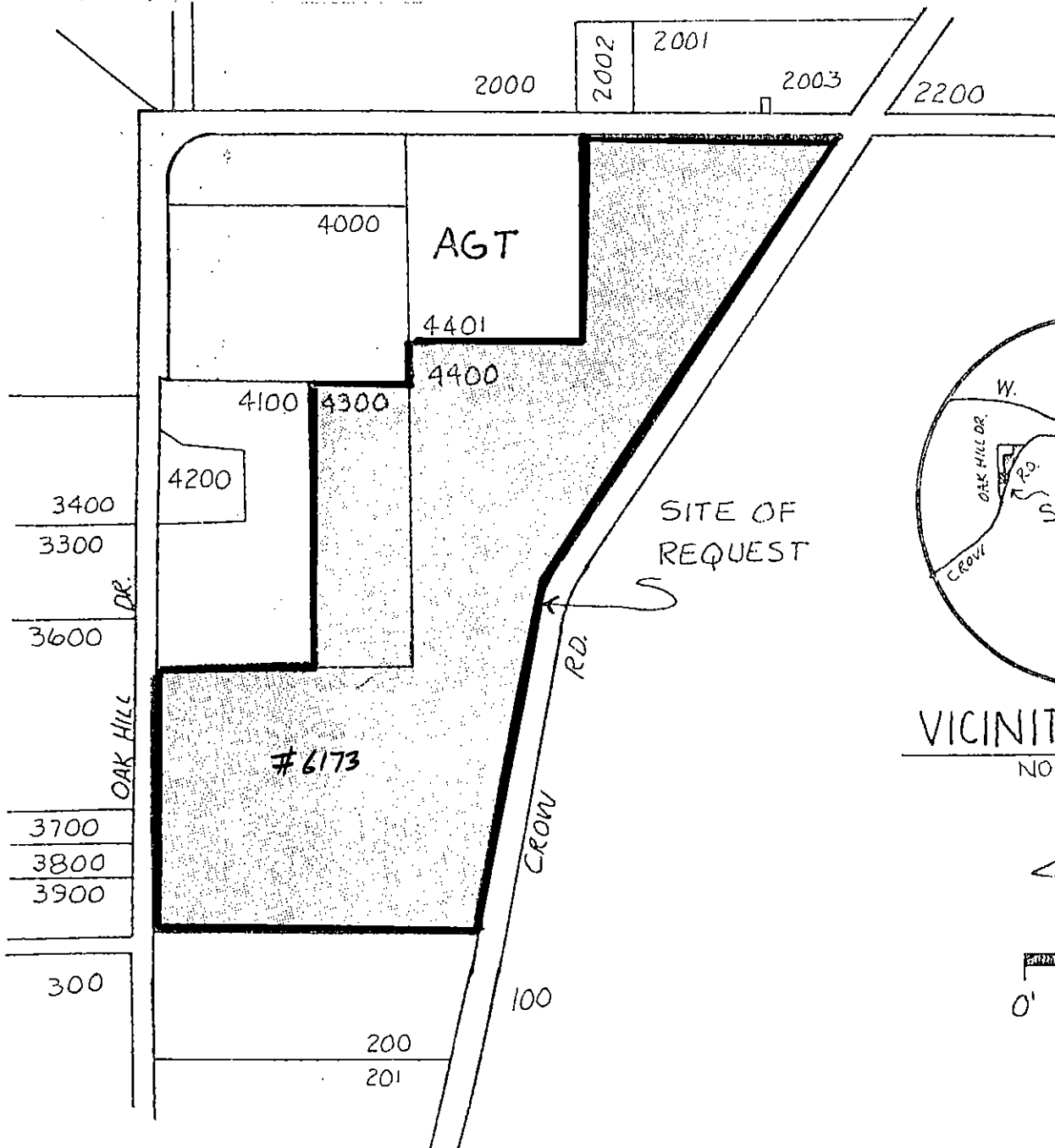

VICINITY MAP

NO SCALE

