

APPROVED

FILED

IN THE BOARD OF COUNTY COMMISSIONERS OF LANE COUNTY, OREGON

AT.....O'CLOCK.....M

LANE COUNTY ZONING AND LAND USE
ORDINANCE NO. 844

) IN THE MATTER OF REZONING CERTAIN
) LAND IN SECTION 13, TOWNSHIP 16
) SOUTH, RANGE 6 WEST, W.M., FROM
) FARM FORESTRY (FF-20) DISTRICT
) TO AGRICULTURE, GRAZING AND TIMBER
) RAISING (AGT-5) DISTRICT
) (ZC 80-136)

NOV 3 1980

D.M. FENOLD, Director of
General Services of Lane County
Gladys Beckel
DEPUTY

The Board of County Commissioners of Lane County ordains as follows:

Under authority of the applicable sections of ORS Chs 203 and 215 and Chs 10 and 12 of Lane Code, the land described as Tax Lot 904, Assessor's Map 16-06-13, and generally depicted on Exhibit "A" attached hereto and incorporated herein by reference, and generally located at 25050 Hall Road, Cheshire is hereby zoned from Farm Forestry (FF-20) District to Agriculture, Grazing and Timber Raising (AGT-5) District.

An emergency is hereby declared to exist and this ordinance, being enacted by the Board in the exercise of its police power for the purpose of meeting such emergency and for the immediate preservation of the public peace, health, and safety, shall take effect immediately upon approval of an Order adopting Findings of Fact in support of this Ordinance.

Enacted this 29 day of October , 1980.

[Signature]
Chairman, Lane County Board of Commissioners

[Signature]
Recording Secretary for this Meeting of the Board

APPROVED AS TO FORM
DATE 8/1/80 lane county
[Signature]
OFFICE OF LEGAL COUNSEL

In the Matter of Rezoning Certain Land in Section 13, Township 16 South, Range 6 West, W.M., from Farm Forestry (FF-20) District, to Agriculture, Grazing and Timber Raising (AGT-5) District (ZC 80-136)

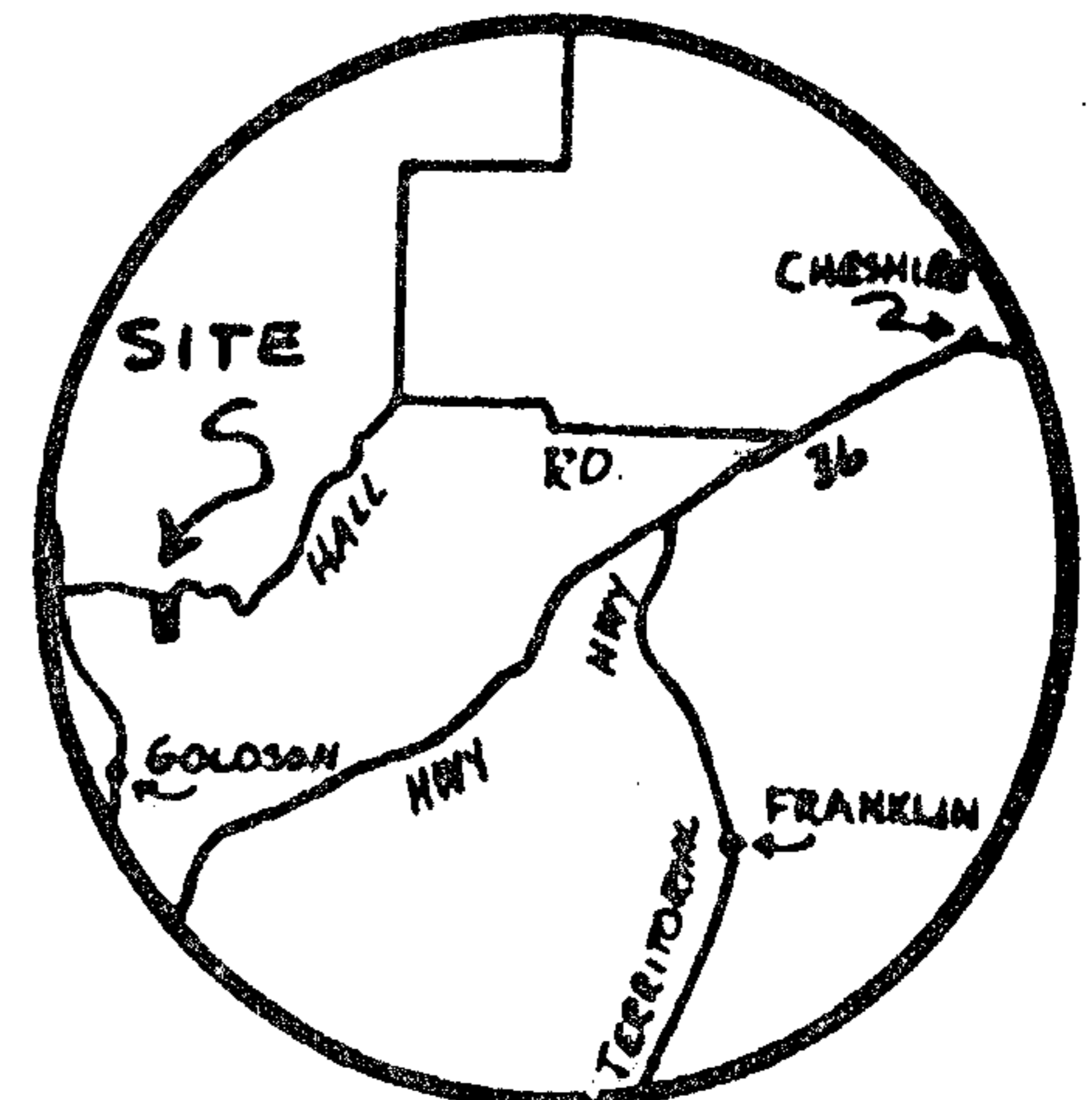
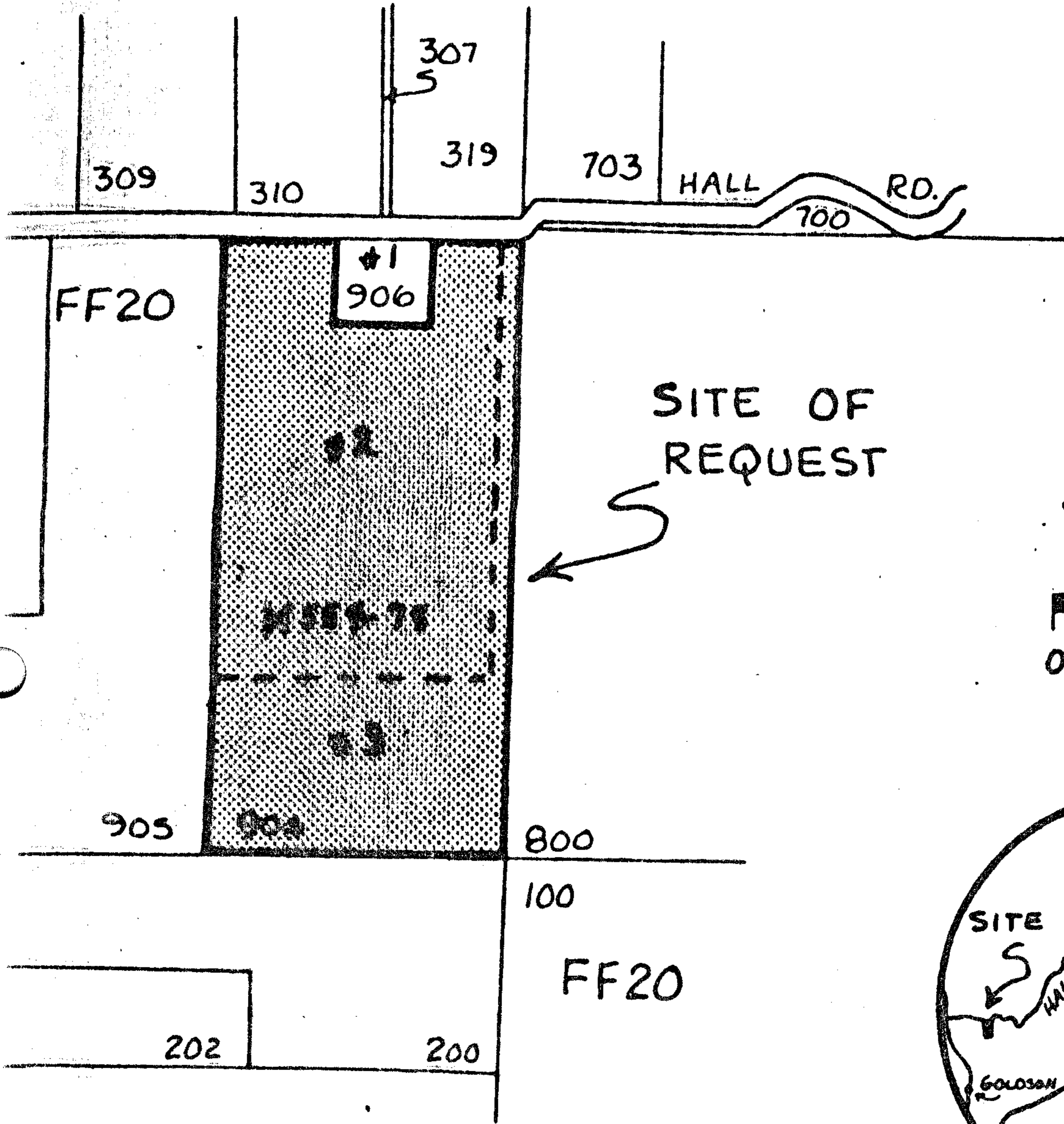

VICINITY MAP
NO SCALE