

ORIGINAL

BOOK 161 PAGE 2099

IN THE BOARD OF COUNTY COMMISSIONERS OF LANE COUNTY
STATE OF OREGON

FILED

DEC 28 1998

File No. 3985

COUNTY CLERK

BY M. Bullock

IN THE MATTER OF THE ALTERATION OF A PORTION OF)
COUNTY ROAD NO. 200 (COMMONLY KNOWN AS RIVER)
ROAD) FROM PARK AVENUE TO CORLISS LANE BEING)
LOCATED WITHIN SECTIONS 13, 14 AND 24, TOWNSHIP 17)
SOUTH, RANGE 4 WEST OF THE WILLAMETTE MERIDIAN)

FINAL ORDER
NO.
98-12-16-9

THIS MATTER now coming before the Board of County Commissioners for Lane County, Oregon, and the Board through adoption of the Capital Improvement Program for the Department of Public Works has determined that it was necessary to alter and reconstruct a portion of River Road, County Road No. 200; and

WHEREAS, through adoption of the Capital Improvement Programs FY 1977-78 to 1981-82 through FY 1989-90 to 1993-94; Resolution and Order No. 80-4-16-12 and Resolution and Order Number 87-03-4-13, the Board of Commissioners authorized The Lane County Department of Public Works to proceed with the design, preparation of construction plans, and acquisition of right of way of the sections of River Road from East Howard Avenue to Federal Lane and Fir Lane to Maxwell Road which includes this portion of the road from Park Avenue to Corliss Lane; and

WHEREAS, Public Hearings were held on February 19, 1980 at North Eugene High School for the East Howard Avenue to Federal Lane section and December 17, 1986 at Kelly Middle School for the Fir Lane to Maxwell Road section of River Road regarding the proposed road improvements and upon consideration of public testimony and recommendations, decisions were made that the Public Works Department should proceed with the final road designs and begin right of way acquisitions; and

WHEREAS, the Department of Public Works has acquired all necessary right of way on and over which the project has been laid out; and

WHEREAS, the Public Works Director has proceeded with the construction of River Road in accordance with the plans and specifications prepared and administered by the Public Works Department; and

WHEREAS, it has been determined necessary to legally alter this portion of River Road and accept the alignment including acquisitions made as a part of this project, as county road right of way; and

WHEREAS, the Department of Public Works has filed road surveys with the County Surveyor for public record all in compliance with ORS 209.250 and 368.106; and

WHEREAS, the Board of County Commissioners is satisfied that necessary road construction and improvements have been completed and will be of public utility and benefit; now therefore, it is hereby

ORDERED that the deeds or portions thereof which lie within the road right of way specified herein, presented to the said Board of County Commissioners through purchase, donation, or agreement, as herein set forth below, on the dates set after the names of the Grantors, and before the recording information in the Lane County Deed Records, are hereby accepted as County road right of way:

FINAL ORDER - RIVER ROAD (PARK AVENUE TO CORLISS LANE)

BOOK 161 PAGE 2100

<u>GRANTOR'S</u>	<u>RECORDING DATE</u>	<u>LANE COUNTY DEED RECORDS</u>	<u>LANE COUNTY TAX LOT NUMBER</u>
Donald R. and Geraldine Gott	Apr. 21, 1988	Reel 1510R RR 8815700	17-04-24-40 2400
J. R. Stults	Mar. 16, 1989	Reel 1563R RR 8911432	17-04-24-31 7600
Koinonia Ministries	Feb. 28, 1989	Reel 1561R RR 8909111	17-04-24-31 4500
Dale R. Christiansen June F. Christiansen	May 15, 1989	Reel 1572R RR 8920736	17-04-24-31 4400 4300
Joseph Dean Belcher	June 21, 1989	Reel 1579R RR 8926735	17-04-24-31 4200
Margot R. Delaney	June 27, 1988	Reel 1520R RR 8825363	17-04-24-31 4100
Patricia Robinson	May 24, 1988	Reel 1515R RR 8820229	17-04-24-31 2400
N. Nelson Grubbe	May 24, 1988	Reel 1515R RR 8820230	17-04-24-31 2400
Roderick D. Jensen Julie M. Jensen	Apr. 4, 1989	Reel 1566R RR 8914431	17-04-24-31 2300
Virgil W. Samms Olin M. Byerly David K. Hills Fred L. Shepard Catherine M. Shepard	Jan. 12, 1961	Reel 165-61D RR 20563	17-04-24-31 2100
L. K. Properties	Sept. 25, 1989	Reel 1595R RR 8943192	17-04-24-31 2000 1900
L. K. Properties	Sept. 25, 1989	Reel 1595R RR 8943193	17-04-24-31 1800
L. K. Properties	Oct. 2, 1969	Reel 454R RR 82881	17-04-24-31 1800 1700
L. K. Properties	Sept. 25, 1989	Reel 1595R RR 8943191	17-04-24-31 1700

FINAL ORDER - RIVER ROAD (PARK AVENUE TO CORLISS LANE)

Page 2 of 11

Kenneth E. McKay Betty E. McKay	Mar. 26, 1963	Reel 215D RR 4618	17-04-24-31	1600
Alice Dalros	Dec. 2, 1988	Reel 1547R RR 8850710	17-04-24-31	1600
Kenneth E. McKay Betty P. McKay	June 6, 1963	Reel 220D RR 13293	17-04-24-31	1500
Mid Oil Company, etal.	May 21, 1998	Reel 2421R RR 9839132	17-04-24-31	1500
Margaret J. Ellis Frey	Mar. 26, 1963	Reel 215D RR 4616	17-04-24-31	1400 1300
Arthur H. Braun Marian M. Braun	Mar. 26, 1963	Reel 215D RR 4617	17-04-24-31	1300
Mid Oil Company	Mar. 29, 1993	Reel 1836R RR 9318429	17-04-24-31	1300
Raymond G. Wolfe, Jr. Barbara K. Wolfe	Aug. 16, 1989	Circuit Court Case No. 16-89-04282	17-04-24-24	9300
Raymond G. Wolfe, Jr. Barabara K. Wolfe	Feb. 26, 1992	Reel 1746R RR 9210872	17-04-24-24	9200
Jean A. Atchison	May 21, 1998	Reel 2421R RR 9839133	17-04-24-24	9100
Ralph A. Kindler Marion E. Kindler	July 10, 1962	Reel 198D RR 75721	17-04-24-24	9001 9000
U. S. National Bank of Portland	May 21, 1958	Reel 115-58D RR 39317	17-04-24-24	8501
Mittleman Properties	Mar. 8, 1993	Reel 1831R RR 9314001	17-04-24-24	8501
Mollie A. Hanson	June 8, 1960	Reel 154-60D RR 1438	17-04-24-24	8300 8302
Mamie Ragin	May 2, 1958	Reel 114-58D RR 37900	17-04-24-24	8202

BOOK 161 PAGE 2102

Lloyd Kruse, etal.	May 24, 1990	Circuit Court Case No. 16-89-04285	17-04-24-24	7900
James Edwin Barnes Cornelia Barnes	Feb. 2, 1989	Reel 1557R RR 8905546	17-04-24-24	7800
Sam F. Konnie Roberta K. Konnie	May 16, 1990	Reel 1632R RR 9022551	17-04-24-24	6900
Roberta K. Konnie Jack S. Morgan Elaine C. Morgan James Edwin Barnes Cornelia Barnes	May 7, 1990	Circuit Court Case No. 16-89-03542	17-04-24-24	6900
Gull Industries, Inc.	May 16, 1990	Reel 1632R RR 9022552	17-04-24-24	6700 6600
Gull Industries, Inc.	May 7, 1990	Circuit Court Case No. 16-89-02714	17-04-24-24	6700 6600
Kennedy and Kennedy	May 21, 1998	Reel 2421R RR 9839134	17-04-24-24	4200
Marian E. Randall	Feb. 2, 1990	Reel 1615R RR 9006093	17-04-24-24	4000 4100
Goodwill Industries of Lane County	Feb. 2, 1990	Reel 1615R RR 9006094	17-04-24-24	4000 4100
William Hargreaves Anna H. Hargreaves Harold C. Hagg Frances Anna Hagg	Nov. 20, 1957	Reel 107-57D RR 26249	17-04-24-24	2100 2000
Clarence Jastad Erma A. Jastad	May 21, 1958	Reel 195D RR 70175	17-04-24-24	1800
River Road Women's Club-Federated	Feb. 6, 1989	Reel 1558R RR 8906009	17-04-24-24	1700
River Road Park and Recreation District	Feb. 6, 1989	Reel 1558R RR 8906010	17-04-24-24	1700

FINAL ORDER - RIVER ROAD (PARK AVENUE TO CORLISS LANE)

Page 4 of 11

Edwin H. Guilford Mildred S. Guilford	June 5, 1989	Reel 1576R RR 8923904	17-04-24-22	3100
Jonathan Mathews	May 31, 1990	Circuit Court Case 16-89-04283	17-04-24-22	3000
Ollie E. Harrington	Nov. 3, 1988	Reel 1542R RR 8846397	17-04-24-22	2900
Richard L. Collver Letha M. Collver	Apr. 7, 1989	Reel 1567R RR 8914913	17-04-24-22	2800
Glen Edward Scott Doris R. Scott	May 9, 1989	Reel 1571R RR 8919737	17-04-24-22	2701
Celia Harriman Judy E. Naham	May 9, 1989	Reel 1571R RR 8919738	17-04-24-22	2701
Alan R. Harriman Tsukiko S. Harriman (AKA Tsukiko Oda)	May 9, 1989	Reel 1571R RR 8919739	17-04-24-22	2701
Alan R. Harriman Tsukiko S. Harriman Trans-Western Investors, Inc. Benjamin Karpman Eunice Karpman	Oct. 19, 1989	Circuit Court Case 16-89-02787	17-04-24-22	2700
Michael Gerot Elizabeth Gerot	Sept. 6, 1989	Reel 1592R RR 8939931	17-04-24-22	1200
Michael William Gerot Elizabeth Frances Gerot	Sept. 6, 1989	Reel 1592R RR 8939932	17-04-24-22	100
Gustave P. Koberstein Louise M. Koberstein	July 26, 1989	Reel 1585R RR 8932708	17-04-24-21	7500
Alice O. Corbly	Mar. 2, 1989	Reel 1561R RR 8909500	17-04-24-21	7400
River Road Baptist Church	July 21, 1989	Reel 1584R RR 8932021	17-04-24-21	7300
River Road Baptist Church	July 21, 1989	Reel 1584R RR 8932020	17-04-24-21	7000
Galen L. Ritchie Elisabeth C. Ritchie	Jan. 9, 1989	Reel 1553R RR 8901085	17-04-24-21	6900

Kathryn L. Brooks	Jan. 31, 1989	Reel 1557R RR 8905069	17-04-24-21	3300
Rose M. Hatfield Trustee	Apr. 26, 1989	Reel 1570R RR 8917824	17-04-24-21	3201
Carlyle F. Pickett and Dorothy Pickett	May 26, 1954	Reel 38-54D	17-04-24-21	
Neva C. Healey	Apr. 20, 1988	Reel 1509R RR 8815365	17-04-24-21	3100
Laulette Norton	Jan. 26, 1989	Reel 1556R RR 8904501	17-04-24-21	3000
Lloyd E. Schumacher Vivian D. Schumacher	July 6, 1989	Reel 1581R RR 8929384	17-04-24-21	1900
Lloyd E. Schumacher Vivian D. Schumacher	July 6, 1989	Reel 1581R RR 8929383	17-04-24-21	1800
Harriett E. Smith	Jan. 4, 1989	Reel 1552R RR 8900475	17-04-24-21	500
Betty Harmon	May 8, 1988	Reel 1543R RR 8847394	17-04-24-21	400
Virginia S. Vaughan Reginald O. Vaughan	Feb. 27, 1990	Circuit Court Case No. 16-89-01605	17-04-13-34 17-04-13-34	3100 3000
City of Eugene	June 29, 1998	Reel 2435R RR 9850335	17-04-13-34	100
Anna L. Widders	Oct. 18, 1989	Reel 1598R RR 8947037	17-04-13-33	8700
Mabel A. Kingsley	Jan. 19, 1989	Reel 1555R RR 8902818	17-04-13-33	8600
Harry J. Rossow Carolyn Black Rossow	Sept. 29, 1989	Reel 1595R RR 8944243	17-04-13-33	6300
Marie C. Schmitz Personal Representative Estate of Peter Schmitz, Jr.	May 26, 1989	Reel 1575R RR 8922803	17-04-13-33 17-04-13-33	4600 6200
Marie C. Schmitz	May 26, 1989	Reel 1575R RR 8922802	17-04-13-33 17-04-13-33	4600 6200

BOOK 161 PAGE 2105

Church of Christ	Mar. 6, 1991	Circuit Court Case 16-90-07830	17-04-13-33	2100
Mabel A. Kingsley	Jan. 10, 1989	Reel 1553R RR 8901438	17-04-13-33	2000
Mabel A. Kingsley	May 21, 1998	Reel 2421R RR 9839135	17-04-13-33	1700
Mabel A. Kingsley	Jan. 10, 1989	Reel 1553R RR 8901439	17-04-13-33	1700
Robert S. Kreindel Sandra L. Kreindel	Nov. 29, 1989	Reel 1604R RR 8953871	17-04-13-33	1600
Berth J. Kingsley Oyler	May 27, 1988	Reel 1515R RR 8820891	17-04-13-33 17-04-13-33	1500 1600
Robert Kreindel Sandra Kreindel	Oct. 7, 1988	Reel 1538R RR 8842097	17-04-13-33	1300
Meryl M. Loy Dora M. Loy Marvin M. Loy	Mar. 16, 1989	Reel 1563R RR 8911374	17-04-13-33	1100
Agness E. Stutz	Feb. 20, 1990	Circuit Court Case 16-89-01794	17-04-13-33	1000
L. H. Bain Margaret Bain	June 1, 1955	Reel 60-55D RR 58043	17-04-13-33	901
William Victor Chapman Lula M. Chapman	Jan. 3, 1962	Reel 186D RR 55035	17-04-13-33	801
Janice L. Lunsford	April 25, 1991	Reel 1692R RR 9118983	17-04-13-33	400
Charles D. Johnson Estate	Sept. 29 1989	Reel 1595R RR 8944241	17-04-13-33 17-04-13-33	300 200
Charles D. Johnson Estate	Sept. 29, 1989	Reel 1595R RR 8944242	17-04-13-33	100
James D. Brown Dale L. Brown Effie B. Brown	Jan. 11, 1968	Reel 376R RR 10617	17-04-13-32	5201
United States National Bank of Oregon	Oct. 4, 1983	Reel 1265R RR 8335584	17-04-13-32	5000

FINAL ORDER - RIVER ROAD (PARK AVENUE TO CORLISS LANE)

Page 7 of 11

Transamerica Title Insurance Company	Oct. 4, 1983	Reel 1265R RR 8335585	17-04-13-32	5000
J. R. Stufts Norma L. Stufts	Aug. 10, 1964	Reel 248D RR 67355	17-04-13-32	4800
Daniel Klemp Ann L. Klemp	Dec. 14, 1983	Reel 1275R RR 8347297	17-04-13-32	4800
Don Forum Rhea E. Forum	Dec. 20, 1983	Reel 1276R RR 8347966	17-04-13-32	4800
Pacific Northwest Bell Telephone Co.	Sept. 10, 1971	Reel 548R RR 62882	17-04-13-32	4700
Pacific Northwest Bell Telephone Company	Apr. 22, 1982	Reel 1189R RR 8211823	17-04-13-32	4700
Pacific Northwest Bell Telephone Co.	July 17, 1962	Reel 199D RR 76594	17-04-13-32	4600
Esther C. Koppe	Feb. 18, 1965	Reel 260D RR 92660	17-04-13-32	4500
Frances Schulze John Carles Schulze	July 24, 1981	Reel 1148R RR 8132025	17-04-13-32	3100
Frances Schulze John Schulze, etal.	Jan. 12, 1990	Circuit Court Case 16-88-08724	17-04-13-32	3100
Mary Huber Culwell	June 7, 1982	Reel 1196R RR 8216361	17-04-13-32	2900
Mary Huber Culwell	July 1, 1988	Reel 1522R RR 8826335	17-04-13-32	2900
Jack Ephrem Tony Ephrem Harold B. McCourt	Feb. 5, 1990	Reel 1615R RR 9006274	17-04-13-32	2800
Jack Ephrem Tony Ephrem Annie Ephrem	July 9, 1981	Reel 1145R RR 8129737	17-04-13-32	2800
Ronald W. Holaday Donna M. Holaday	June 17, 1988	Reel 1519R RR 8824096	17-04-13-32	2700
Ronald W. Holaday Donna M. Holaday	May 12, 1982	Reel 1192R RR 8213947	17-04-13-32	2700

FINAL ORDER - RIVER ROAD (PARK AVENUE TO CORLISS LANE)

Page 8 of 11

BOOK 161 PAGE 2107

Louis Koppe Ester G. Koppe	Feb. 25, 1959	Reel 129-59D RR 60834	17-04-13-32	
Ella A. King	Nov. 30, 1989	Circuit Court Case No. 16-89-01795	17-04-13-32	1500
Raymond O. Hafdahl Priscilla S. Hafdahl	Feb. 25, 1983	Reel 1233R RR 8306168	17-04-13-32	1400
Ann B. Orth	Dec. 6, 1983	Reel 1274R RR 8345140	17-04-13-32	1200
Ann B. Orth ETAL	June 8, 1982	Circuit Court Case No. 16-82-04751	17-04-13-32	1200
Scott E. Forbes	May 5, 1982	Reel 1191R RR 8213208	17-04-13-32	1100
Carmel L. McCracken Mary Lois McCracken	Jan. 25, 1983	Reel 1229R RR 8302639	17-04-13-32	1100
Andrew T. Nordahl Sylvia E. Nordahl	Jun. 22, 1981	Reel 1142R RR 8126625	17-04-13-32	600
Philip H. Edblom Freda M. Edblom	Nov. 30, 1981	Reel 1169R RR 8149215	17-04-13-32	500
Donald F. Roggenbuck Elizabeth L. Roggenbuck	Aug. 10, 1982	Reel 1205R RR 8223350	17-04-13-32	400
Jack Norris Helen R. Norris Jack Howard Norris Nona B. Norris	Sept. 16, 1981	Reel 1157R RR 8139695	17-04-13-32	200
Jack Norris Helen R. Norris Jack Howard Norris Nona B. Norris	Sept. 16, 1981	Reel 1157R RR 8139696	17-04-13-32	100
Robb B. Bokich	Aug. 12, 1985	Reel 1362R RR 8528277	17-04-13-23 (17-04-13-20-5400) Original Tax Lot	1300
Ollie E. Harrington	July 20, 1981	Reel 1147R RR 8131308	17-04-13-23 (17-04-13-20-5300) Original Tax Lot	1200

FINAL ORDER - RIVER ROAD (PARK AVENUE TO CORLISS LANE)

Page 9 of 11

BOOK 161 PAGE 2108

Douglas Gene Miner Joy L. Miner	Dec. 7, 1981	Reel 1170R RR 8150020	17-04-13-23 1100 (17-04-13-20-5200) Original Tax Lot
Thomas W. Beall Emma Jane Beall	Jan. 5, 1983	Reel 1226R RR 8300324	17-04-13-23 600 (17-04-13-20-5100) Original Tax Lot
Thomas W. Beall Emma Jane Beall	Jan. 5, 1983	Reel 1226R RR 8300323	17-04-13-23 400 (17-04-13-20-5000) Original Tax Lot
Mario Capaldo Yolando Capaldo	June 7, 1982	Reel 1196R RR 8216363	17-04-14-14 3900 (17-04-13-32-5100) Original Tax Lot
Ilse K. Hoffman Bernd D. Hoffman Marianne Robotis	June 7, 1982	Reel 1196R RR 8216365	17-04-14-14 3900 (17-04-13-32-5100) Original Tax Lot
Garden Court Joint Venture	June 7, 1982	Reel 1196R RR 8216366	17-04-14-14 3800 (17-04-14-10-6500) Original Tax Lot
Bert F. Smith Lottis S. Smith Fred Jacobson Emilie Jacobson	Jan. 10, 1946	Book 307 Page 348	17-04-14-14
Gertrude D. Pittman	Sept. 16, 1982	Reel 1210R RR 8227824	17-04-14-14 1100 (17-04-13-20-5600) Original Tax Lot
Gertrude D. Pittman	Sept. 16, 1982	Reel 1210R RR 8227823	17-04-14-14 1000 (17-04-13-20-5500) Original Tax Lot

and, it is further

ORDERED, that the portion of said county road referred to above and commonly known as River Road be hereby altered as described in the legal description attached hereto, made a part hereof and marked Exhibit 'A' by this Order, and it is further

ORDERED, that all portions of County Road Number 200 lying between the termini specified herein above which are not included within the limits of the road herein above described are **HEREBY DECLARED VACATED** in accordance with ORS 368.126, retaining, however, unto any and all existing public utilities the right to preserve, maintain, repair, replace, remove or reinstall any public utility that may now exist

BOOK 161 PAGE 2109

within the bounds of the portions of County Road No. 200 herein described by these proceedings as vacated; and it is further

ORDERED, that a road plat depicting the right of way limits of this project be prepared by the County Surveyor and filed for public record in the County Surveyors Office and in the County Road Files in compliance with ORS chapter 368; and, it is further

ORDERED, that in support of this action, the said Board of County Commissioners does hereby adopt the report of the Director of Public Works as set forth in Exhibit "B", which is attached hereto, and made a part hereof, by this Order; and, it is further

ORDERED, that this Order be entered into the records of the Lane County Board of Commissioners Journal of Administration and into the Road Index Books and County Road Files administered by the Lane County Department of Public Works and the Lane County Surveyor and that said Order be, and is hereby final and does operate to alter a portion of County Road Number 200, herein known as River Road.

DATED this 16~~th~~ of Dec, 1998

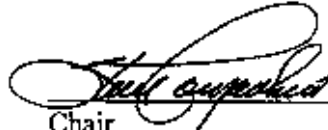

Chair

Lane County Board of Commissioners

APPROVED BY THE BOARD

Date: 12-8-98 Lane County



OFFICE OF LEGAL COUNSEL

EXHIBIT "A"

RIVER ROAD
(Park Avenue to Corliss Lane)

CENTERLINE DESCRIPTION

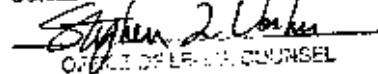
A strip of land lying northerly of the easterly extension of the north line of Park Avenue and southerly of the westerly extension of south line of Corliss Lane, said strip being variable feet in width lying on each side of the centerline of River Road in Section 13, 14 and 24, Township 17 South, Range 4 West of the Willamette Meridian, Lane County, Oregon, as surveyed by Lane County in 1979 and 1987; the centerline and widths in feet being described as follows:

Beginning at Engineers' Centerline Station L4 40+78.54 PC, said station being 2412.57 feet North and 399.35 feet East of a Brass Cap marking the Northeast corner of the West one-half of the PRIOR F. BLAIR DONATION LAND CLAIM NUMBER 39 in Township 17 South, Range 4 West of the Willamette Meridian in Lane County, Oregon; RUN thence along a 2,291.83 foot radius curve left (the long chord of which bears North 11° 31' 55" West, 391.77 feet) a distance of 392.24 feet; thence North 16° 26' 06" West, 203.35 feet; thence along a 11,459.16 foot radius curve right (the long chord of which bears North 15° 43' 16" West, 285.60 feet) a distance of 285.61 feet to Engineers' Centerline Station L4 49+59.74 PT Bk = L3 49+57.81 POT Ah; thence North 15° 00' 25 " West 5057.53 feet to Engineers Centerline Station L3 100+15.34 PI; thence North 15° 02' 55" West 1418.02 feet to Engineers' Centerline Station L3 114+33.36 POT = 0+00 Corliss Lane and there ending, all in Lane County, Oregon.

The widths in feet of the strip of land herein described are as follows:

<u>STATION TO STATION</u>		<u>WIDTH ON WEST'LY SIDE OF C/LINE</u>	<u>WIDTH ON EAST'LY SIDE OF C/LINE</u>
L4 41+75.00 POC	L4 42+43.66 POC	50 ft tapering on a straight line to 50 ft	50 ft
L4 42+43.66 POC	L4 43+18.81 POC	50 ft tapering on a straight line to 60 ft	50 ft
L4 43+18.81 POC	L4 43+29.00 POC	60 ft tapering on a straight line to 50 ft.	50 ft
L4 43+29.00 POC	L4 44+41.00 POC		50 ft
L4 44+41.00 POC	L4 44+49.00 POC		50 ft tapering on a straight line to 60 ft

<u>STATION TO STATION</u>		<u>WIDTH ON WEST'LY SIDE OF C/LINE</u>	<u>WIDTH ON EAST'LY SIDE OF C/LINE</u>
L4 44+49.00 POC	L4 44+86.43 POT		60 ft tapering on a straight line to 72.31 ft
L4 44+86.43 POT	L4 45+03.00 POT		72.31 ft tapering on a straight line to 50 ft
L4 45+03.00 POT	L3 50+00.00 POT		50 ft
L4 43+29.00 POC	L4 46+70.00 POT	50 ft	
L4 46+70.00 POT	L4 46+83.20 POC	50 ft tapering on a straight line to 60 ft	
L4 46+83.20 POC	L4 47+24.74 POC	60 ft	
L4 47+24.74 POC	L4 47+33.50 POC	60 ft tapering on a straight line to 50 ft	
L4 47+33.50 POC	L3 50+88.03 POT	50 ft	
L3 50+00.00 POT	L3 50+05.70 POT		50 ft tapering on a straight line to 60 ft
L3 50+05.70 POT	L3 50+30.90 POT		60 ft
L3 50+30.90 POT	L3 50+45.00 POT		60 ft tapering on a straight line to 50 ft
L3 50+45.00 POT	L3 55+41.00 POT		50 ft
L3 50+88.03 POT	L3 51+53.76 POT	50 ft tapering on a straight line to 60 ft	
L3 51+53.76 POT	L3 51+60.00 POT	60 ft tapering on straight line to 50 ft	
L3 51+60.00 POT	L3 55+17.23 POT	50 ft	

STATION TO STATIONWIDTH ON WEST'LY
SIDE OF C/LINEWIDTH ON EAST'LY
SIDE OF C/LINE

L3 55+17.23 POT	L3 55+72.52 POT	50 ft tapering on a straight line to 60 ft	
L3 55+72.52 POT	L3 55+85.00 POT	60 ft tapering on a straight line to 50 ft	
L3 55+41.00 POT	L3 55+52.49 POT		50 ft tapering on a straight line to 60 ft
L3 55+52.49 POT	L3 55+85.96 POT		60 ft
L3 55+85.96 POT	L3 56+00.00 POT		60 ft tapering on a straight line to 50 ft
L3 56+00.00 POT	L3 59+14.00 POT		50 ft
L3 55+85.00 POT	L3 60+14.00 POT	50 ft	
L3 60+14.00 POT	L3 61+89.65 POT	50 ft tapering on a straight line to 49.85 ft	
L3 59+14.00 POT	L3 59+27.20 POT		50 ft tapering on a straight line to 70 ft
L3 59+27.20 POT	L3 59+80.30 POT		70 ft tapering on a straight line to 50 ft
L3 59+80.30 POT	L3 62+99.00 POT		50 ft
L3 62+99.00 POT	L3 63+05.77 POT		50 ft tapering on a straight line to 60 ft
L3 63+05.77 POT	L3 63+60.96 POT		60 ft tapering on a straight line to 50 ft

STATION TO STATIONWIDTH ON WEST'LY
SIDE OF C/LINEWIDTH ON EAST'LY
SIDE OF C/LINE

BOOK 161 PART 2113

L3 63+60.96 POT	L3 73+27.00 POT		50 ft
L3 61+89.65 POT	L3 65+61.23 POT	49.85 ft tapering on a straight line to 49.74 ft	
L3 65+61.23 POT	L3 66+46.20 POT	49.74 ft tapering on a straight line to 49.73 ft	
L3 66+46.20 POT	L3 67+31.12 POT	49.73 ft tapering on a straight line to 49.74 ft	
L3 67+31.12 POT	L3 68+16.17 POT	49.74 ft tapering on a straight line to 49.82 ft	
L3 68+16.17 POT	L3 69+30.86 POT	49.82 ft tapering on a straight line to 49.76 ft	
L3 69+30.86 POT	L3 70+00.19 POT	49.76 ft tapering on a straight line to 60 ft	
L3 70+00.19 POT	L3 70+09.00 POT	60 ft tapering on a straight line to 50 ft	
L3 70+09.00 POT	L3 76+51.50 POT	50 ft	
L3 73+27.00 POT	L3 73+34.92 POT		50 ft tapering on a straight line to 60 ft
L3 73+34.92 POT	L3 73+84.68 POT		60 ft tapering on a straight line to 50 ft
L3 73+84.68 POT	L3 76+91.34 POT		50 ft

STATION TO STATIONWIDTH ON WEST'LY
SIDE OF C/LINEWIDTH ON EAST'LY
SIDE OF C/LINE

BOOK 161 PAGE 2114
L3 76+51.50 POT L3 76+64.63 POT

50 ft tapering
on a straight
line to 60 ft

L3 76+64.63 POT L3 77+16.70 POT

60 ft

L3 77+16.70 POT L3 77+24.00 POT

60 ft tapering
on a straight
line to 50 ft

L3 76+91.34 POT L3 77+40.74 POT

50 ft tapering
on a straight
line to 60 ft

L3 77+40.74 POT L3 77+54.00 POT

60 ft tapering
on a straight
line to 50 ft

L3 77+54.00 POT L3 82+42.30 POT

50 ft

L3 77+24.00 POT L3 80+38.00 POT

50 ft

L3 80+38.00 POT L3 80+51.39 POT

50 ft tapering
on a straight
line to 60 ft

L3 80+51.39 POT L3 81+03.50 POT

60 ft

L3 81+03.50 POT L3 81+11.00 POT

60 ft tapering
on a straight
line to 50 ft

L3 81+11.00 POT L3 93+61.00 POT

50 ft

L3 82+42.30 POT L3 82+85.00 POT

50 ft tapering
on a straight
line to 57 ft

L3 82+85.00 POT L3 83+20.00 POT

57 ft

STATION TO STATIONWIDTH ON WEST'LY
SIDE OF C/LINEWIDTH ON EAST'LY
SIDE OF C/LINE

BOOK 161 PAGE 2115

L3 83+20.00 POT	L3 83+40.00 POT		57 ft tapering on a straight line to 50 ft
L3 83+40.00 POT	L3 86+70.00 POT		50 ft
L3 86+70.00 POT	L3 86+76.84 POT		50 ft tapering on a straight line to 60 ft
L3 86+76.84 POT	L3 87+21.32 POT		60 ft tapering on a straight line to 50 ft
L3 87+21.32 POT	L3 89+74.26 POT		50 ft
L3 89+74.26 POT	L3 90+12.08 POT		50 ft tapering on a straight line to 60 ft
L3 90+12.08 POT	L3 90+27.50 POT		60 ft tapering on a straight line to 50 ft
L3 90+27.50 POT	L3 100+50.00 POT		50 ft
L3 93+61.00 POT	L3 93+74.11 POT	50 ft tapering on a straight line to 60 ft	
L3 93+74.11 POT	L3 94+26.63 POT	60 ft	
L3 94+26.63 POT	L3 94+34.00 POT	60 ft tapering on a straight line to 50 ft	
L3 94+34.00 POT	L3 97+20.00 POT	50 ft	

STATION TO STATIONWIDTH ON WEST'LY
SIDE OF C/LINEWIDTH ON EAST'LY
SIDE OF C/LINE

BOOK 161 PAGE 2116

L3 97+20.00 POT	L3 97+27.50 POT	50 ft tapering on a straight line to 60 ft	
L3 97+27.50 POT	L3 97+69.50 POT	60 ft	
L3 97+69.50 POT	L3 97+80.00 POT	60 ft tapering on a straight line to 50 ft	
L3 97+80.00 POT	L3 101+20.00 POT	50 ft	
L3 100+50.00 POT	L3 100+61.70 POT		50 ft tapering on a straight line to 60 ft
L3 100+61.70 POT	L3 100+64.56 POT		60 ft tapering on a straight line to 50 ft
L3 100+64.56 POT	L3 105+00.00 POT		50 ft
L3 101+20.00 POT	L3 101+75.00 POT	50 ft tapering on a straight line to 53 ft	
L3 101+75.00 POT	L3 102+57.70 POT	53 ft	
L3 102+57.70 POT	L3 103+43.40 POT	53 ft tapering on a straight line to 59.4 ft	
L3 103+43.40 POT	L3 103+50.00 POT	59.4 ft tapering on a straight line to 50 ft	
L3 103+50.00 POT	L3 110+80.00 POT	50 ft	
L3 105+00.00 POT	L3 105+50.00 POT		50 ft tapering on a straight line to 53 ft
L3 105+50.00 POT	L3 106+50.00 POT		53 ft

STATION TO STATION

WIDTH ON WEST'LY
SIDE OF C/LINE

WIDTH ON EAST'LY
SIDE OF C/LINE

BOOK 161 PAGE 2117

L3 106+50.00 POT L3 107+00.00 POT

53 ft tapering
on a straight
line to 50 ft

L3 107+00.00 POT L3 111+15.00 POT

50 ft

L3 110+80.00 POT L3 110+91.40 POT

50 ft tapering
on a straight
line to 60 ft

L3 110+91.40 POT L3 111+33.20 POT

60 ft

L3 111+33.20 POT L3 111+45.00 POT

60 ft tapering
on a straight
line to 50 ft

L3 111+45.00 POT L3 115+00.00 POT

50 ft

L3 111+15.00 POT L3 111+50.00 POT

50 ft tapering
on a straight
line to 53 ft

L3 111+50.00 POT L3 112+75.00 POT

53 ft

L3 112+75.00 POT L3 113+20.00 POT

53 ft tapering
on a straight
line to 50 ft

L3 113+20.00 POT L3 115+00.00 POT

50 ft

The bearings used herein are based upon the Oregon Coordinate System of 1927, South Zone.

BOOK 161 PAGE 2118
EXHIBIT "B"

IN THE BOARD OF COUNTY COMMISSIONERS OF LANE COUNTY
STATE OF OREGON

File No. 3985

IN THE MATTER OF THE ALTERATION OF A PORTION OF)
COUNTY ROAD NO. 200 (COMMONLY KNOWN AS RIVER) DIRECTOR'S
ROAD) FROM PARK AVENUE TO CORLISS LANE, BEING) REPORT
LOCATED WITHIN SECTIONS 13, 14 AND 24, TOWNSHIP 17)
SOUTH, RANGE 4 WEST OF THE WILLAMETTE MERIDIAN)

River Road (County Road No. 200) was originally established in 1856. The altered segment of the road from Park Avenue to Corliss Lane is approximately 7100 feet in length. A portion of the road lies within the Urban Growth Boundary of the City of Eugene. Other portions lie within the City Limits, but are not presently surrendered to the City. River Road is designated as a Principal Arterial in the Lane County Master Road Plan providing a means of public transportation from the city of Eugene to Junction City. Increased usage of the road by motorists, pedestrians and bicyclists indicated a need for improvement for the safety of the traveling public in this area.

Public Hearings were held for the East Howard to Federal Lane portion on February 19, 1980 at North Eugene High School and for the Fir Lane to Maxwell portion on December 17, 1986 at Kelly Middle School regarding the proposed road improvements for River Road. Upon consideration of public testimony and recommendations, a decision was made that the Lane County Public Works Department should proceed with the final road design and begin right of way acquisitions.

Through Capital Improvement Programs from FY 1977-78 to 1981-82 through FY 1989-90 to FY 1993-94, Resolution and Order No. 80-4-16-12 and Resolution and Order No. 87-03-4-13, the Lane County Board of Commissioners authorized the Lane County Department of Public Works to proceed with the design, preparation of construction plans, and acquisitions of right of way for the improvement of River Road from Fir Lane to Federal Lane which includes the portion from Park Avenue to Corliss Lane to be altered.

The River Road project construction plans were prepared and all necessary re-surveying, alignment design and mapping, additional right of way acquisition and reconstruction has been completed. All construction of this portion of road was completed in accordance with plans and specifications administered by the Department of Public Works.

A Final Order to legally alter this portion of River Road has been prepared. The Order provides for acceptance of parcels of land and portions thereof acquired as right of way in

BOOK 161 PAGE 2119

conjunction with this project and vacates portions of the former right of way determined to be in excess. The Order will establish a right of way for that portion which is scheduled to be surrendered to the City of Eugene according to the October, 1996 Intergovernmental Agreement between the City of Eugene and Lane County. The legal description of the new alignment including right of way widths is marked Exhibit "A" and attached to the Final Order.

The Department of Public Works has filed surveys with the County Surveyor, which include centerline and right of way monumentation in compliance with ORS Chapters 209 and 368. Road plats depicting the right of way limits of this project has been prepared by the County Surveyor.

Upon approval, the Final Order will be filed with the County Clerk's Office and recorded in the Board of Commissioners Journal of Administration. The Final Order and road plats will be filed and indexed into the Road Index Books and legal County Road Files administered by the Department of Public Works and the County Surveyor.

DATED this 1st day of DECEMBER, 1998

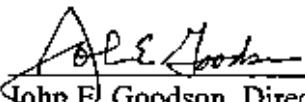

John E. Goodson, Director
Department of Public Works

ATTACHMENT "A"

ORIGINAL

BOOK 161 PAGE 2120

END

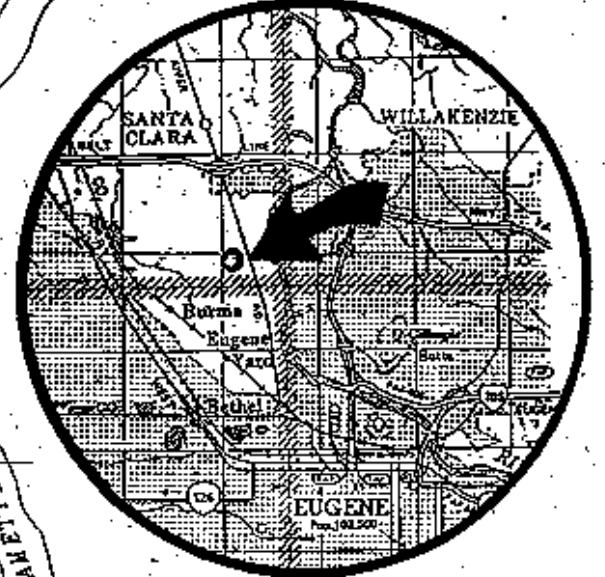

VICINITY MAP

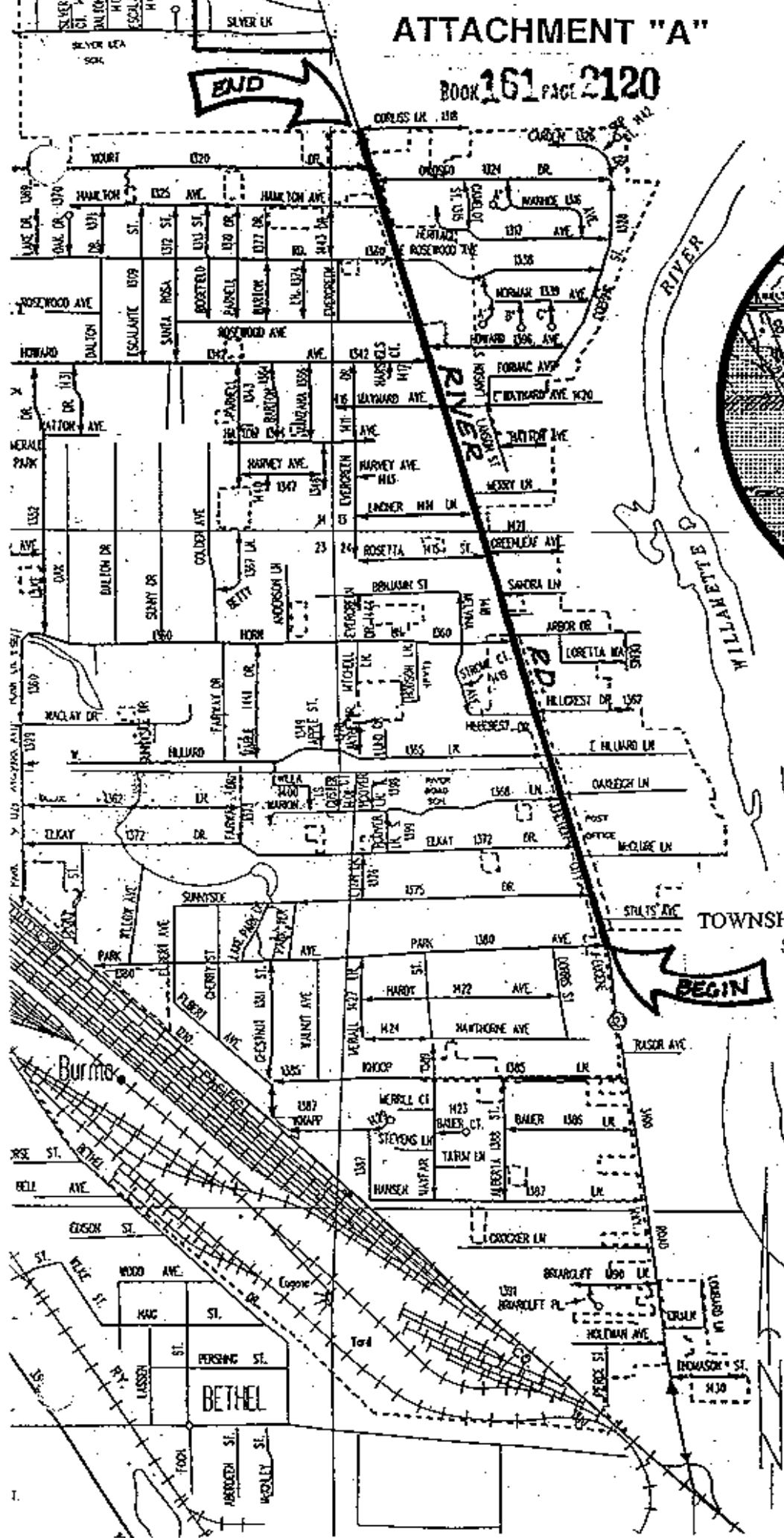

TOWNSHIP 17 SOUTH, RANGE 4 WEST, W. W. SECTIONS 13, 14, AND 24