

BEFORE THE BOARD OF COUNTY COMMISSIONERS
OF LANE COUNTY, OREGON

ORIGINAL

IN THE MATTER OF ACCEPTING A DEED OF LAND)
TO BE USED AS A PUBLIC ROAD EASEMENT FOR)
LATTA ROAD, A PUBLIC ROAD (17-01-23-32))

ORDER NO.

07-11-20-13

THIS MATTER now coming before the Board of County Commissioners of Lane County and Paul M. Oestreich, owning land within Lane County which is not within the limits of an incorporated city or town, having on this day presented to the Board of County Commissioners of Lane County a good and sufficient deed, said deed being properly executed and forever dedicating a portion of such land to the use of the public for road purposes and granting a public road easement, and the Board of County Commissioners of Lane County deeming it proper, as a convenience for property owners in the area and as a benefit to the general public, to accept said deed for a public road easement;

NOW, THEREFORE, IT IS HEREBY ORDERED that the said deed shall be and is hereby accepted by the Board of County Commissioners of Lane County as a public road easement and not as a county road; and

IT IS FURTHER ORDERED that the above Order shall be entered in the records of the Board of County Commissioners' Journal of Administration, Lane County, Oregon; and

IT IS FURTHER ORDERED that the deed be recorded in the Deed Records of the County and the Instrument Number be noted on this Order.

DATED this 29th day of November, 2007.

DEPARTMENT OF PUBLIC WORKS
LAND MANAGEMENT DIVISION

LANE COUNTY BOARD OF
COMMISSIONERS

Approved October 31, 2007.

By Faye Starr
Chair

By Craig Starr
Craig Starr, Interim Division Manager

Deed Instrument Number _____, Lane County, Oregon Deed Records.

Att: Map

DEDICATION OF A PUBLIC ROAD EASEMENT

PAUL M. OESTREICH

GRANTOR, grants and dedicates to LANE COUNTY, a political subdivision of the State of Oregon (**GRANTEE**) a public road easement on and over the following described property:

A parcel of land lying in the Northwest One Quarter (NW ¼) of the Southwest One Quarter (SW ¼) of Section 23, Township 17 South, Range 1 West of the Willamette Meridian, and being a portion of the tract of land conveyed to Paul M. Oestreich by that certain Personal Representative's Deed recorded on October 23, 1986 on Reel 1426R, Recorder's Reception Number 8642346 as a correction to that Personal Representative's Deed recorded on September 18, 1986 on Reel 1420R, Recorder's Reception Number 8636201, Lane County, Oregon, Deed Records, said parcel being more particularly described as follows:

Beginning at the Southwest corner of the Southeast One Quarter (SE ¼) of the Northwest One Quarter (NW ¼) of Section 23, Township 17 South, Range 1 West of the Willamette Meridian; thence North 0°06'55" West 346.91 feet to a point; thence South 89°53'05" West 60.00 feet to a point on the westerly right of way of Latta Road as established by deed recorded May 23, 1966, Reel 288-D, Instrument No. 48310; thence following said westerly right of way of Latta Road South 0°06'55" East 463.91 feet to the TRUE POINT OF BEGINNING of this dedication; thence South 89°53'05" West 35.00 feet to a point; thence South 0°06'55" East 20.00 feet to a point; thence North 89°53'05" East 35.00 feet to a point on said westerly right of way of Latta Road; thence North 0°06'55" West 20.00 feet to the True Point of Beginning, all in the Northwest One Quarter (NW ¼) of the Southwest One Quarter (SW ¼) of Section 23, Township 17 South, Range 1 West of the Willamette Meridian, Lane County, Oregon.

The bearings and distances herein are based upon the deed from Jacob H. Koch, Paul L. Oestreich and Arlette Oestreich to Lane County for road purposes recorded May 23, 1966, Reel 288-D, recorder's reception number 48310.

It being the intent herein to acquire right-of-way for Latta Road, a public road which, with this dedication, will result in a right-of-way of 65 feet width from centerline as said road abuts the GRANTOR'S property.

There is no consideration for this dedication.

Said parcel being forever dedicated to the use of the public for road purposes and granting a public road easement.

Dated this 17th day of September, 2007.

Paul M. Oestreich
Paul M. Oestreich

STATE OF OREGON)
COUNTY OF LANE) ss.

The foregoing instrument was acknowledged before me this 17th day of September 2007,
by Paul M. Oestreich.



Constance R. Rea
Notary Public for Oregon
My Commission expires: March 29, 2010

DEPARTMENT OF PUBLIC WORKS
LAND MANAGEMENT DIVISION

Approved October 31, 2007

By Craig Starr
Craig Starr, Interim Division Manager

The Board of Commissioners
hereby accepts and approves for
for recording this dedication
as described herein.

LANE COUNTY BOARD OF
COMMISSIONERS

By Faye Starr
Chair

APPROVED AS TO FORM
Date 11-8-07 lane county
[Signature]
OFFICE OF LEGAL COUNSEL

NW1/4SW1/4 Section 23, T. 17 S. R. 1 W., W.M.

LANE COUNTY

NO SCALE

15
14
22
23
500

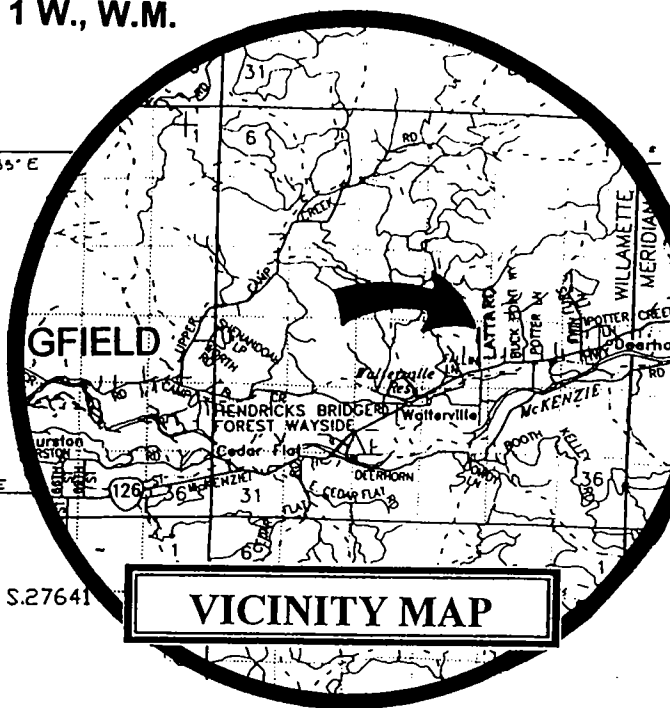
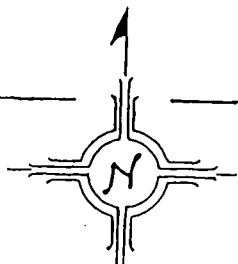

VICINITY MAP

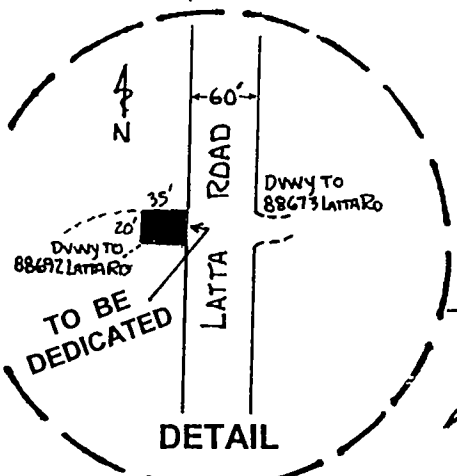

DETAIL

MAP 17-01-23

TO BE DEDICATED (see detail)

SEE MAP 17-01-23

(N. 08° 02' 00" W.)
(2594.41')
APPROX. 1/4 COR.

NE COR. J. Latta D.L.C. 42

TL 600

MAP 17-01-23-30

88697 Latta Rd

606 2.19 AC.

607 1.06 AC.

603

600

700

605

602

601

604

608

609

610

604

603

602

601

600

599

598

603

602

601

600

599

598

597

602

601

600

599

598

597

596

601

600

599

598

597

596

595

600

599

598

597

596

595

594

599

598

597

596

595

594

593

598

597

596

595

594

593

592

597

596

595

594

593

592

591

596

595

594

593

592

591

590

595

594

593

592

591

590

589

594

593

592

591

590

589

588

593

592

591

590

589

588

587

592

591

590

589

588

587

586

591

590

589

588

587

586

585

590

589

588

587

586

585

584

589

588

587

586

585

584

583

019-09

Grant of Easement and Maintenance Agreement

For value received, receipt of which is hereby acknowledged, Denise M and Paul M Oestreich (Grantors), hereby grant, transfer and convey to parcels 017-01-23-00-00600, 017-01-23-00-00601, and 017-01-23-00-00605 (Grantees), a perpetual nonexclusive easement to use a strip of land 30 feet wide, being 15 feet wide on each side of centerline, centerline of which is described as follows:

Beginning at the Southwest corner of the Southeast One Quarter (SE ¼) of the Northwest One Quarter (NW ¼) of Section 23, Township 17 South, Range 1 West of the Willamette Meridian; thence N 89° 50' 20" W 15 feet to the point of beginning of this easement; thence North 0° 06' 55" W 361.91 feet to a point; thence S 89°53'05"W 523.62 feet to the west line of parcel 605 as described within this document and there ending this easement.

1. This easement is not personal or in gross but is to be appurtenant to each and every portion of the following described property owned by the Grantees:

Description of parcel 601 is as follows:

Beginning at a point on the quarter line 816.50 feet North 89° 50' 20" West of the center of Section 23 in Township 17 South, Range 1 West of the Willamette Meridian; and run thence parallel with the North-South quarter line of said Section 23, North 00° 13' 10" West 668.01 feet to a point; thence South 63° 39' 05" West 477.51 feet to the beginning point of a curve; thence along a 120.00 foot radius curve to the left having a central angle of 63° 46' a curve length of 133.55 feet by a long chord that bears South 31° 46' 05" West 126.77 feet to the ending point of curve; thence South 00° 06' 55" East 346.91 feet to the Southwest corner of the Southeast one-quarter of the Northwest one-quarter of said Section 23; thence South 89° 50' 20" East 496.50 feet to the place of beginning, all in said Section 23, Lane County, Oregon.

Description of parcel 605 is as follows:

Beginning at the Northeast corner of the John Latta Donation Land Claim No. 42, in the Township 17 South, Range 1 West of the Willamette Meridian; thence South 598.36 feet; thence North 89° 53' 05" East, 29.62 feet; thence North 635.0 feet; thence North 89° 53' 05" East, 509.0 feet; thence along the chord of a 120 foot radius curve to the right North 31° 46' 05" East, 126.77 feet; thence North 15° 51' 55" East, 89.08 feet; thence North 43° 32' 25" West, 298.77 feet; thence North 29° 38' 05" East, 138.93 feet; thence North 89° 53' 05" West, 493.67 feet; thence South 567.63 feet to the point of beginning, in Lane County, Oregon.

